

# JBC

[www.jbctools.com](http://www.jbctools.com)



## Fume Extractor

Ref. FAE2-5A

# Packing List

The following items should be included:

**Fume Extractor** ..... 1 unit  
Ref. FAE2-5A  
*Includes FAE2-100*



**RJ12 direct cable** ..... 2 units  
Ref. 0019755



**Cleaning stick** ..... 1 unit  
Ref. 0004009



**Power cable** ..... 1 unit  
Ref. 0009417 (100V / 120V)  
0009401 (230V)



**Manual** ..... 1 unit  
Ref. 0018826



## Features



# Assembly

For a basic working system you need:

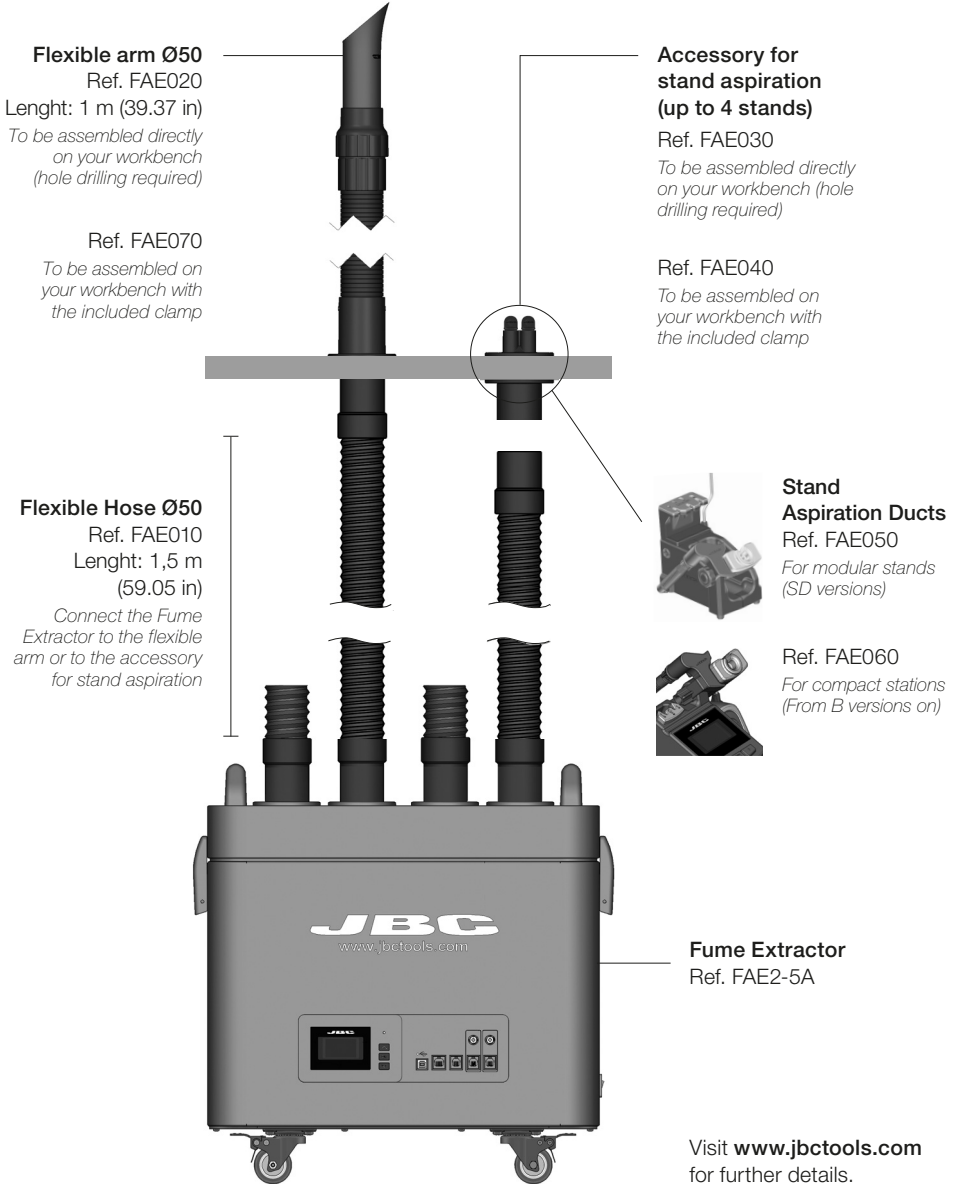

Visit [www.jbctools.com](http://www.jbctools.com) for further details.

## Connection with Excellence range

Connect up to 2 stations directly to the fume extractor.

- For a correct operation always update the latest software version. The minimum required version is number **8886160** for DDE, HDE & NAE stations and number **8886162** for DME stations.
- Connectable to stations through the RJ12 ports.
- Each station controls a port and each tool must be assigned to a port through the peripherals menu.

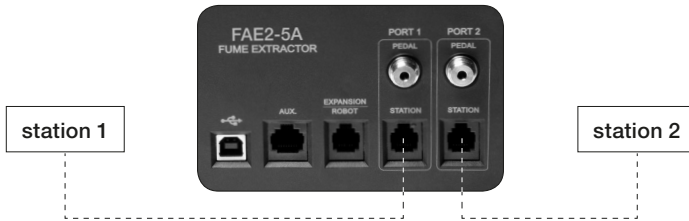

## Connection with QSC-A

Connect many stations to a port of the fume extractor.

- The minimum required version is number **8886164** for JTSE stations.
- Connectable to stations with USB connector except JT-D, TE-D stations and their previous versions.
- If you need more USB connections, join a HUB-USB to the QSC-A. This option allows any tool of any station connected to the QSC-A to activate the fume extractor.

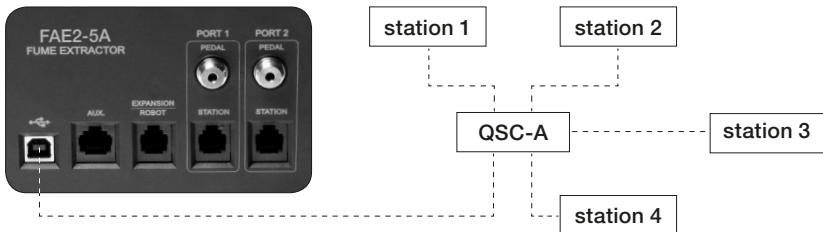

# Working modes

## Autonomous

### Pedal

Activate the vacuum system with the pedal without being connected to a JBC station.

### Continuous mode

The fume extractor works in continuous mode with the four valves opened.

## Remote

### Robot

Manage the fume extractor using a robotic system by means of the RJ12 connector.

### Station

The valve in the working area opens when the tool is lifted from the stand. Once the tool is returned to the stand and enters sleep mode, the valve in the work area closes and the stand valve opens. After a period of inactivity on both ports, the unit stops.

# Aspiration ports control

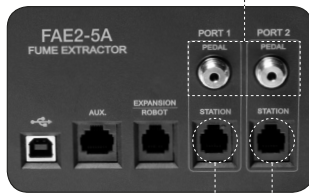

*The pedal connection takes precedence over the RJ12 connection, the equipment will only attend the Pedal port.*

*If an Excellence station is connected by the RJ12 Station **Port 1** it can control all the aspiration tubes.*

*If an Excellence station is connected via RJ12 Station **Port 2** it is only able to control the Work 2 and Stand 2 aspiration tubes.*

## Control Process

### Main Screen

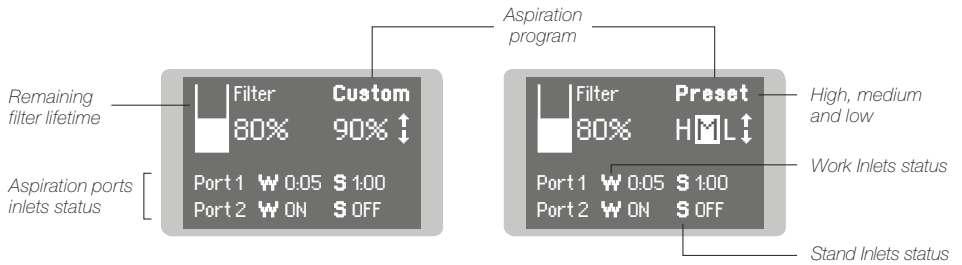

### Main Menu

Original Pin: 0105

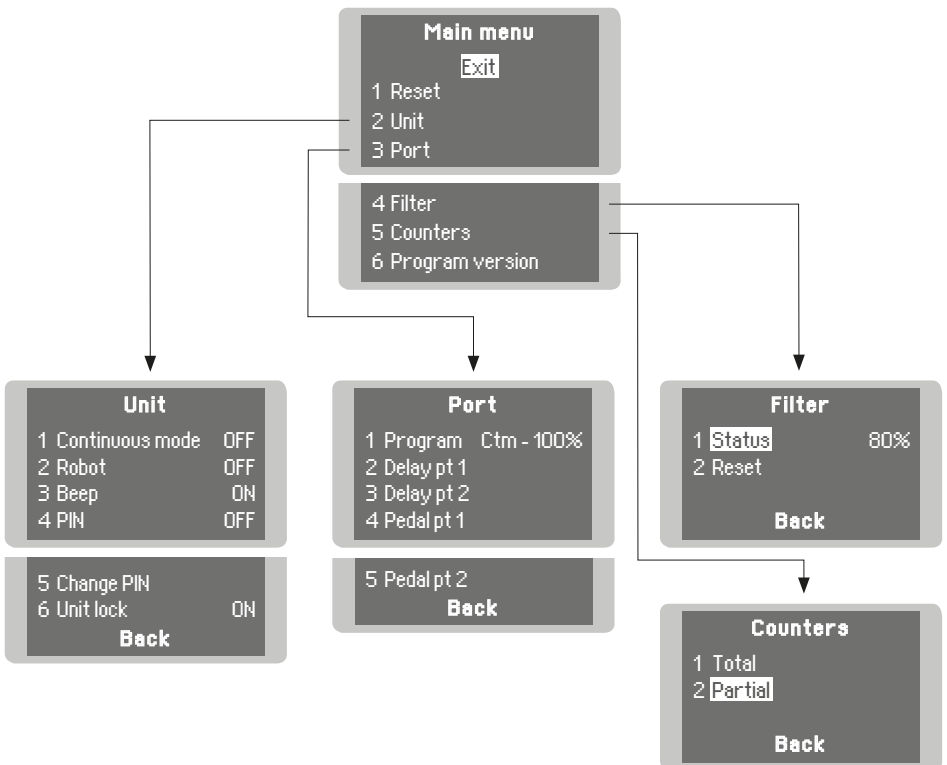

# Control Process

## Unit Screen

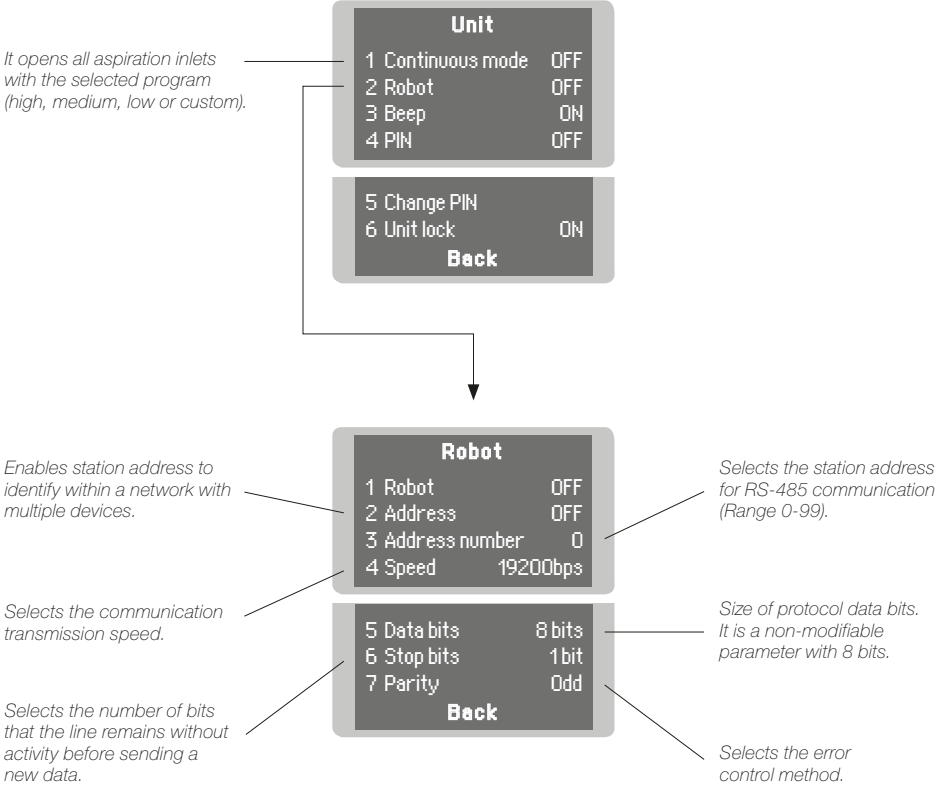



## Control Process

### Port Screen

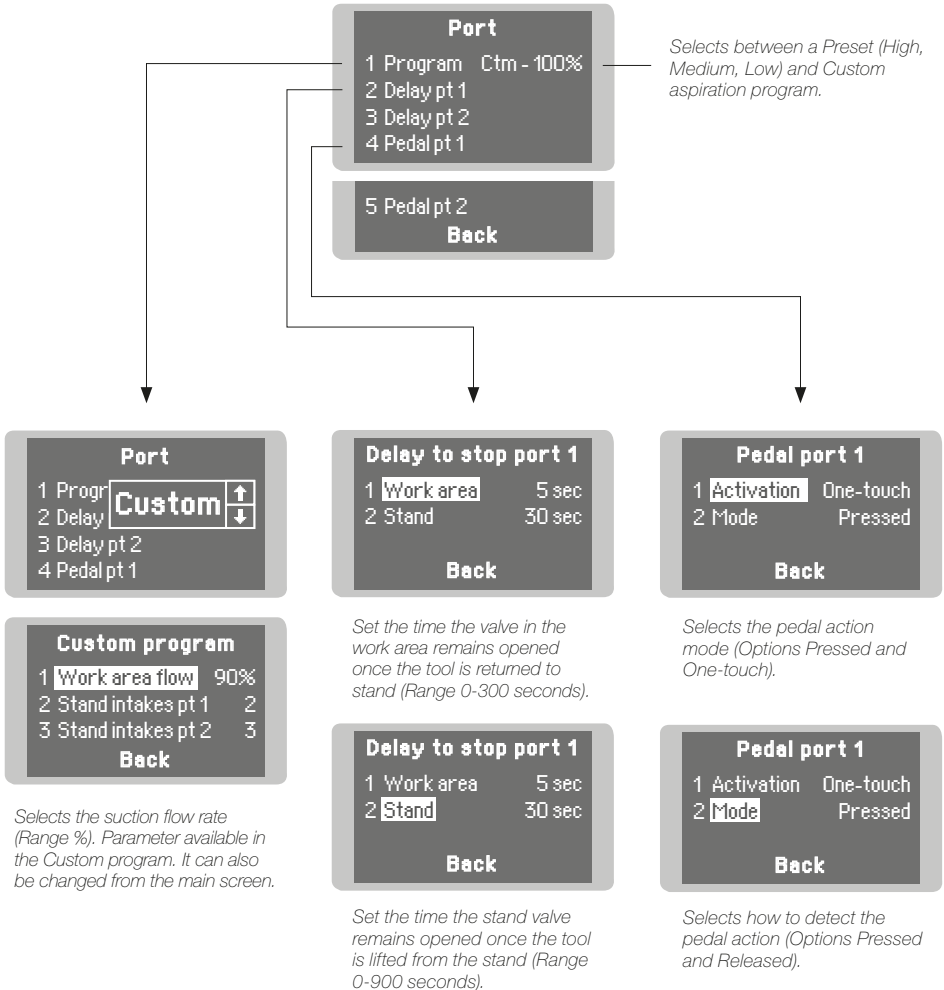

# Maintenance

## Filter replacement

- The unit notifies through both the display and the LED when filters need maintenance.
- To replace the filters, first turn the fume extractor off. Then remove the cover by opening the side closures of the casing.
- If once the pre-filter has been changed the saturation indicator is on, it means that the compact filter is already saturated and must be replaced too.



- The duration of the compact filter is 1 year maximum once its packaging is opened.
- Once the compact filter has been replaced, the filter counter must be reset. (Main Menu > Filter > Reset)
- If the display shows an error when the equipment is switched on, it is probable that the cover and casing connectors are dirty and making false contact. Remove the cover again and clean both connectors.

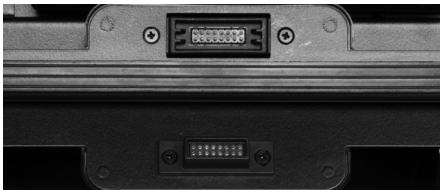

**Pre filter**  
Ref. FAE2-110

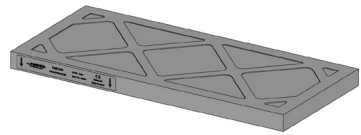

**Compact filter + Pre filter**  
Ref. FAE2-100

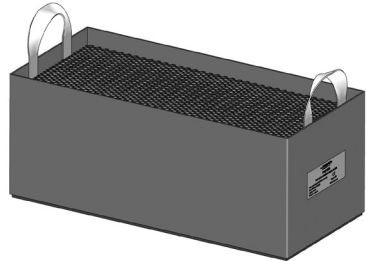

## Maintenance

### Valves

- Check the status of the valves when replacing the pre-filter or the compact filter.
- Use the cleaning stick if necessary and clean with alcohol to remove dirt residues.

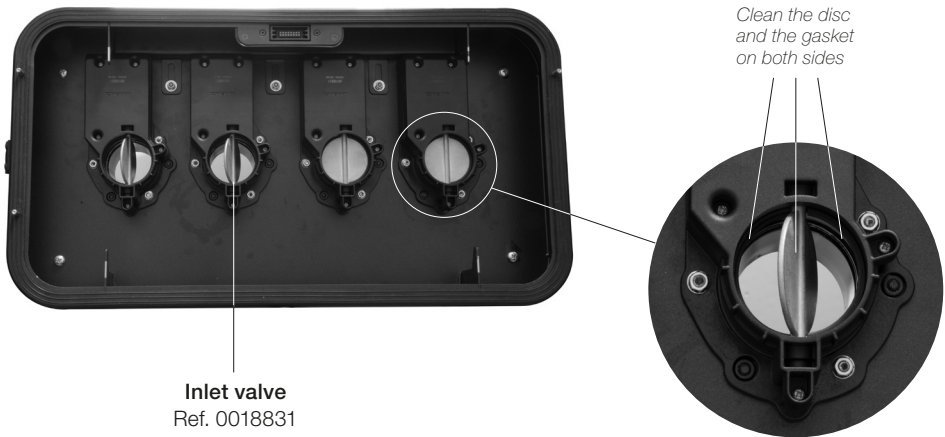

### Latch Adjustment

- The locking force between casing and cover can be adjusted by turning the knurled nut of the locking mechanism.
- Turn clockwise to loosen and counterclockwise to tighten.

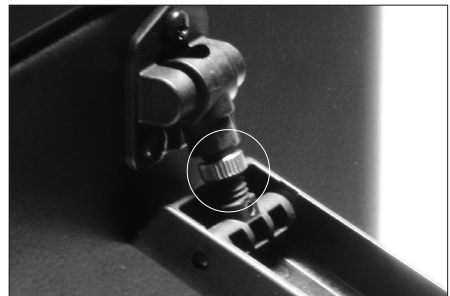

Read safety guidelines to do the equipment maintenance securely.

# Safety



**Follow safety guidelines to prevent electric shock, injury, fire or explosion.**

- The equipment is only designed to filtrate the fumes generated by soldering.
- Do not use the units for the filtration of combustible, explosive or corrosive gasses. Incorrect use may cause fire.
- The power cord must be plugged into approved bases. Be sure that it is properly grounded before use. When unplugging it, hold the plug, not the wire.
- Do not work on electrically live parts.
- Do not leave the appliance unattended when it is on.
- Do not cover the ventilation grills. Heat can cause inflammable products to ignite.
- Avoid flux coming into contact with skin or eyes to prevent irritation.
- This appliance can be used by children over the age of eight and persons with reduced capabilities or lack of experience provided that they have been given adequate supervision or instruction concerning use of the appliance and understand the hazards involved.
- Maintenance must not be carried out by children unless supervised.
- Keep your workplace clean and tidy. Wear appropriate protective mask, glasses and gloves when handling dirt filter or pre-filter.
- The side closures of the casing are only for handling the cover, not the complete equipment.
- Do not use the equipment without the filters.
- Saturated filters can not be cleaned and reused.
- Avoid blowing the filter or the dirty parts of the equipment, if necessary it is advisable to vacuum.
- Avoid losing particles in the filter during handling it.
- Treat the saturated filters as waste depending on the filtered contaminant and the applicable standars in each country. This is the European Waste Catalog classification:
  - 15 02: Absorbents, filter materials, wiping cloths and protective clothing.
  - 15 02 02: Absorbents, filter materials (including oil filters not otherwise specified, wiping cloths, protective clothing contaminated by dangerous substances.
  - 15 02 03: Absorbents, filter materials, wiping cloths and protective clothing.
- In case of not complying with the filter change recommendations, the maximum particle and gas concentrations established in each country could be exceeded.



# Exploded View

**F AE2-5A** 100/120/230V  
FAE2-5A FUME EXTRACTOR



FAE2-5A

0019751 (x2)

## SPARE PARTS

### FAE2-5A:

-CIRCUIT:	0018939
-INLET VALVE:	0018831
-H13 + CARBON + M5 FILTER:	FAE2-100
-M5 PRE-FILTER:	FAE2-110

FAE2-5A 100/120/230V FUSE T-8A

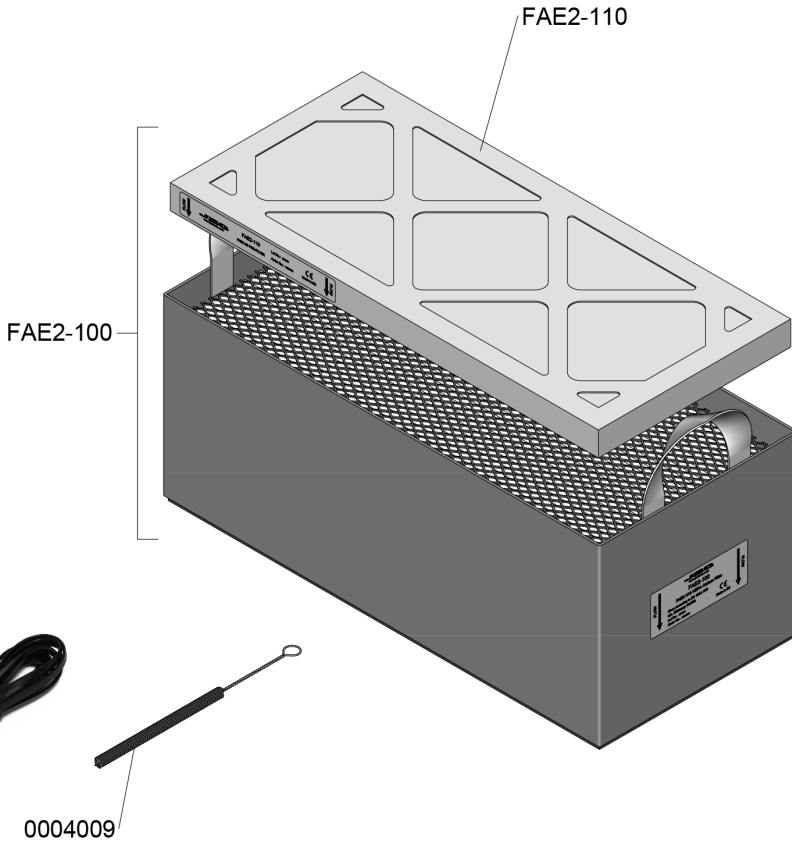

# Specifications

**FAE2-5A** 120V 50/60Hz. Input power: 500W

**FAE2-5A** 230V 50/60Hz. Input power: 500W

**FAE2-5A** 100V 50/60Hz. Input power: 320W

- Weight: 33,6 kg (74.08 lb)
- Dimensions: 558 x 292 x 562 mm (21.97 x 11.50 x 22.13 in)
- Fuse: 8 AT
- Blower type: Brushless
- Max. flow rate: 290 m<sup>3</sup>/h (10241.25 f<sup>3</sup>/h)
- Max. vacuum: 6,1 KPa (0.88 psi)
- Work areas: 2
- Noise: 54 dB
- Pre-filter: Medium dust filter M5 (EN 779)
- Compact Filters: H13 particle filter (EN 1822)  
Activated carbon filter

Complies with CE standards.  
ESD protected.

# JBC

## Warranty

JBC's 2 year warranty covers this equipment against all manufacturing defects, including the replacement of defective parts and labour.

Warranty does not cover product wear or misuse.

In order for the warranty to be valid, equipment must be returned, postage paid, to the dealer where it was purchased. Please register your product warranty within 30 days of purchase in [www.jbctools.com/productregistration](http://www.jbctools.com/productregistration).



This product should not be thrown in the garbage.

In accordance with the European directive 2002/96/EC, electronic equipment at the end of their life must be collected and returned to an authorized recycling facility.



Manual in other languages available on our website

**[www.jbctools.com](http://www.jbctools.com)**